

L SERIES - 180 HEAD SPARE PARTS DIAGRAM

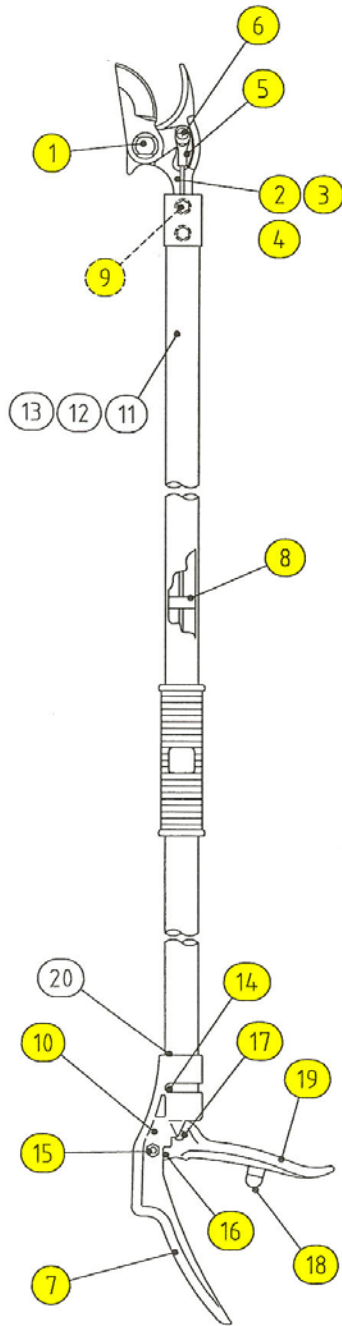

- | | | |
|-----|----------|---|
| 1. | SP-LA216 | Pivot Bolt for Blade Set |
| 2. | SP-LA236 | Rod Set for LA-180L12
(includes end cylinder and rod end cap) |
| 3. | SP-LA237 | Rod Set for LA-180L18
(includes end cylinder and rod end cap) |
| 4. | SP-LA238 | Rod Set for LA-180L21
(includes end cylinder and rod End Cap) |
| 5. | SP-LA264 | Rod End Cap (Bolt with loop to attach blade to rod) |
| 6. | SP-LA259 | Screw Set (attaches blade to rod) |
| 7. | SP-LA79 | Complete Handle Set (includes spring, latch lock set,
pivot bolt, shock absorber, grip lever,
stop screw, sleeve for grip, and grip handle) |
| 8. | SP-LA235 | Rod Holding Disc |
| 9. | SP-LA239 | Bolt with Nut (attaches blade to pipe) |
| 10. | SP-LA101 | Spring for Handle |
| 11. | SP-LA290 | Pipe for LA-180L12 — Special Order |
| 12. | | Pipe for LA-180L18 |
| 13. | SP-LA292 | Pipe for LA-180L21 — Special Order |
| 14. | SP-LA39 | Stop Screw for Handle |
| 15. | SP-LA40 | Pivot Bolt for Handle |
| 16. | SP-LA42 | Latch Lock Set for Handle |
| 17. | SP-LA43 | End Cylinder for Rod |
| 18. | SP-LAXRC | Shock Absorber for Handle |
| 19. | SP-LA145 | Grip Lever Only for Handle |
| 20. | | Sleeve for Grip |

BLADE SETS:

SP-180L1	Replacement Blade Set
----------	-----------------------

*All highlighted items are available from inventory.
All others are available by Special Order.*