

# Assembly instructions for 4052 and 4102 Bicycle Racks

Do not tighten bolts until completely assembled.

1. Starting on either end, the first hole is used only when joining 5' sections into longer racks. If you are doing so, bolt the #10 connector plate to the bottom of #1 Low Profile Base with #5 3/8" x 3/4" hex bolt, lock washer and nut. Then connect the next #1 Low Profile Base to the other end of the first one.

2. Starting with the second hole from either end, place a #2 Low Profile Saddle over the hole, place a #3 Low Profile Tube over the top of that and insert a #4 3/8" x 1 3/4" hex bolt through the top of the tube down through the saddle and the base, then place a 3/8" lock washer and 3/8" nut on the end.

3. Place another saddle and the other base under the other end of the Low Profile Tube. Insert a 3/8" x 1 3/4" hex bolt through the assembly and put a lock washer and nut on it.

4. On the 7th hole place a #11 X Brace on the base, then a saddle, then another Low Profile Tube. Insert the 3/8" x 1 3/4" hex bolt through the assembly and place a lock washer and nut on the end.

5. The diagonal brace will go to 8th hole from the end on the other base, place a saddle then another Low Profile Tube over that and insert the 3/8" x 1 3/4" hex bolt through that assembly and place a lock washer and nut on the end.

6. Place all the other Low Profile Tubes and X Braces on in the same manner. When all of the bolts are in place you can tighten all of them.

If this is a 10' Low Profile Bicycle Rack then there will be two sets of X braces. One set placed in the center of each 5' section.

Kay Park Rec  
PO Box 477  
Janesville, IA 50677  
1-800-553-2476

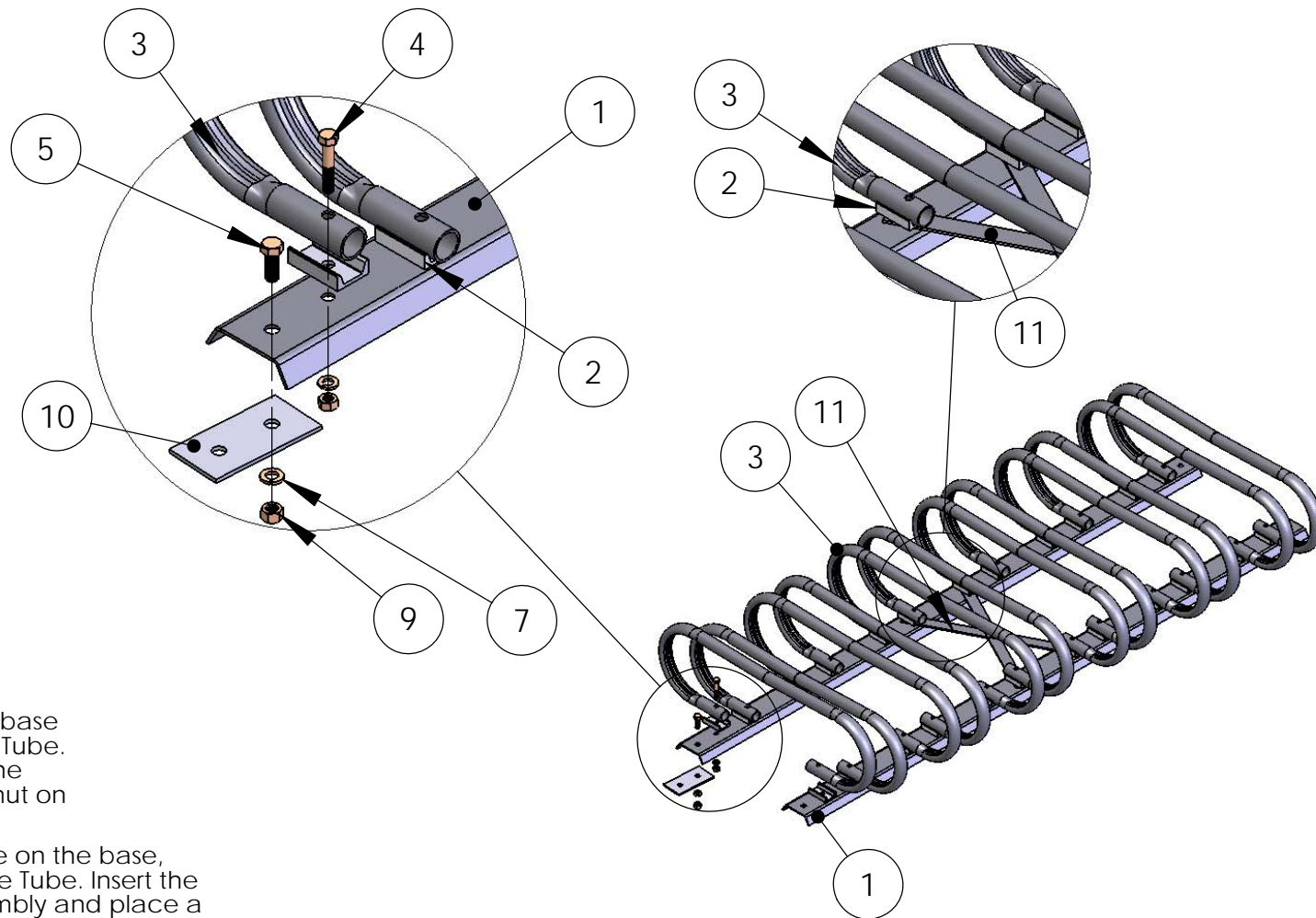

ITEM NO.	PART NUMBER	QTY./5' section
1	Low Profile Base	2
2	Low Profile Saddle	24
3	Low Profile Tube	12
4	HBOLT 0.3125-18x1.75x0.875-S	24
5	HBOLT 0.3750-16x1x1-S	24
6	LW 0.3125	24
7	LW 0.375	1
8	HNUT 0.3125-18-D-S	1
9	HNUT 0.3750-16-D-S	1
10	BR Low Profile Connector Plate	1
11	Low Profile X Brace	2