

IMPORTANT SAFETY INFORMATION

Read and understand all safety precautions and instructions before use.

The Brush Grubber Xtreme is designed for outdoor use. Check Brush Grubber Xtreme before each and every use for signs of wear. Do Not use if damaged or if not working properly. The Brush Grubber Xtreme is designed to remove brush up to 5" diameter.

The Brush Grubber Xtreme is not to be used on people or pets.

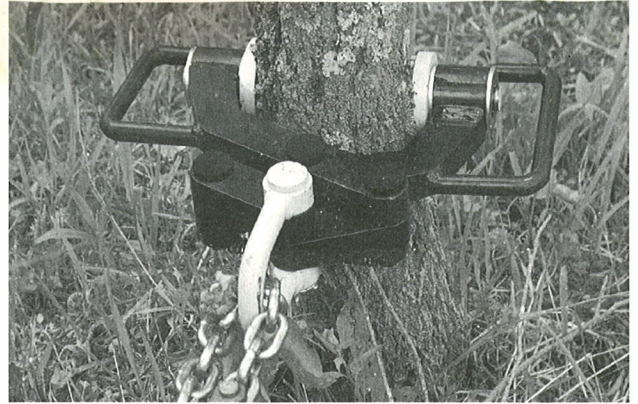

INSTRUCTIONS

1. Cut brush/tree off at 3ft to 4ft above the ground prior to removal.
 2. Place Brush Grubber Xtreme on each side of trunk of brush near the base/ground with **spring on the Brush Grubber Xtreme placed towards the ground** as shown in figure 1.
 3. Securely Attach a chain to the clevis of the Brush Grubber Xtreme and the opposite end of the chain to the towing/pulling vehicle. Take caution that the chain is long enough so the brush will not hit/strike the operator of the towing/pulling vehicle. **DO NOT jerk the Brush Grubber Xtreme while there is slack in the chain.**
 4. To remove the Brush Grubber Xtreme from the trunk of brush push back on the clevis (towards the trunk) or pull jaws open using the large rugged handles on each side of the jaws.
- * **Take caution of all pinch points on the Brush Grubber Xtreme.**
- * **Take caution of Grip Pads when opening the jaws of the Brush Grubber Xtreme. Keep fingers and hands free and clear.**

PARTS DESCRIPTION

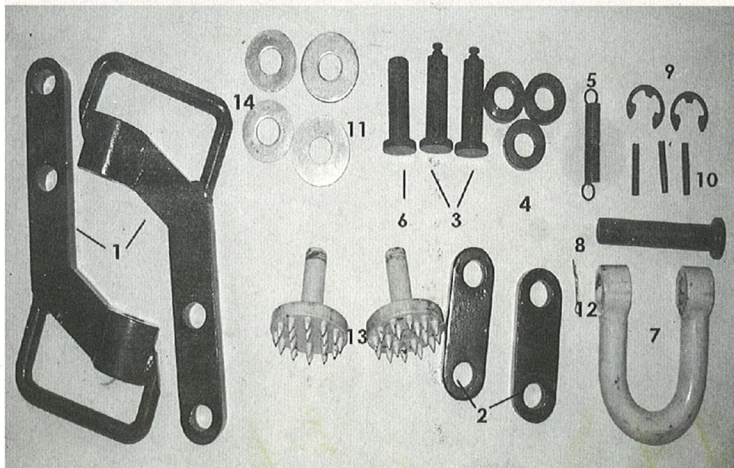

Ref. #	Qty	Part #	Description
1	2	BG11-01	Main Arm
2	2	BG11-02	Clevis Arm
3	2	BG11-03	Spring Shaft Ø18x65mm
4	3	BG11-04	Collar Ø18
5	1	BG11-05	Spring
6	1	BG11-06	Center Shaft Ø18x65mm
7	1	BG11-07	Clevis
8	1	BG11-08	Shaft Ø18x75mm
9	2	BG05-09	E-clip (Grip Pad) Ø10
10	3	BG11-10	Roll Pins
11	4	BG11-11	Large Washer Ø50x2.5mm
12	1	BG11-12	Pin Ø3x40mm
13	2	BG11-13	Grip Pad
14	2	BG11-14	Small Washer Ø50x2.5mm



WARNING

BAC Industries, Inc. and Brush Grubber will not be held liable for any damages, losses or injury due to the misapplication or misuse of this product or any other reason. Always wear approved safety glasses, protective clothing, and proper hand and foot protection at all times. Keep all people, pets, or animals clear from brush removal work area.

Brushgrubber.com
PO BOX 5064
HOPKINS, MN 55343

PH: 952-945-9058
www.brushgrubber.com
Email: info@brushgrubber.com